

PS-LX250H

SERVICE MANUAL

Ver 1.1 2001.06

*US Model
Canadian Model
AEP Model
UK Model*



SPECIFICATIONS

Motor and Platter

Drive system	Belt-drive
Motor	DC motor
Platter	295 mm dia. (aluminum, die-cast)
Speeds	33 1/3 and 45 r/min, 2 speed
Wow and flutter	Less than 0.25% (WRMS)
Signal to noise ratio	More than 50 dB (DIN-B)

Tone Arm

Type	Dynamic balanced straight shaped with soft damping control
Effective arm length	195 mm

General

Power requirements	U.S.A. and Canada: 120 V AC, 60 Hz European countries: 230 V, 50/60 Hz
Power consumption	2 W
Dimensions	Approx. 420 x 100 x 342 mm (w/h/d)
Mass	2.7 kg

Supplied Accessories

45 r/min adaptor (1)
Platter (with drive belt) (1)
Rubber mat (1)
Dust cover (1)

Design and specifications are subject to change without notice.

Replacing the Stylus

The life expectancy of the stylus tip is about 500 hours. To preserve maximum sound quality and avoid damage to your records, we recommend replacing the stylus within this time limit. Additional replacement styli (ATN3600LX) are available from your Sony dealer.

To replace the stylus

- 1 Turn off the amplifier.
- 2 Grasp the stylus holder and pull it away from the body of the cartridge.
- 3 Insert the new stylus by pushing it into the cartridge receptacle.

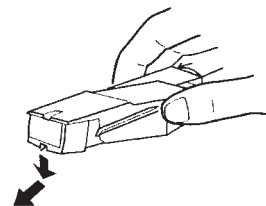

STEREO TURNTABLE SYSTEM

9-928-858-12
2001F0200-1
© 2001.6

Sony Corporation
Home Audio Company
Shinagawa Tec Service Manual Production Group

SONY®

Assembling the Turntable

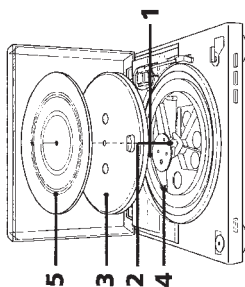

- 1 Set the EQ switch according to the jacks of your stereo system (amplifier).
 - When your stereo system (amplifier) has PHONO input jacks (connect to PHONO input jacks) →set to OFF.
 - When your stereo system (amplifier) does not have PHONO input jacks (connect to AUX, VIDEO input jacks, etc.) →set to ON.

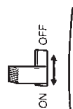

- 2 Move the metallic parts inside the larger gear in the direction of arrows.



When the power is supplied after assembling or moving the turntable

The turntable sometimes rotates and the tone arm descends to the platter even if START is not pressed. If this occurs, press STOP to return the tone arm to the arm stand.

- 3 Carefully, place the platter on the spindle.

- 4 Using the ribbon, loop the drive belt around the motor pulley. After looping the belt, do not forget to remove the ribbon.

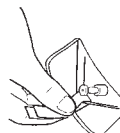

- 5 Place the rubber mat on the platter.

4GB

Installing the dust cover

Insert the hinges on the dust cover into the hinge pockets on the rear of the cabinet.

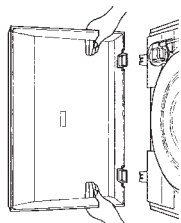

Hooking up the Turntable

The phono cables come attached to the rear of the cabinet.

- 1 Connect the cable with the white plug to the white (L) jack and connect the cable with the red plug to the red (R) jack. Make sure to insert the plugs firmly into the jacks. If the plugs are not inserted firmly, noise may be occurred.

Amplifier

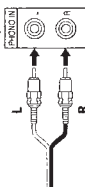

It is necessary to set the EQ switch according to the connected jacks. For details, refer to step 1 in "Assembling the Turntable".

Mains lead hookups

Connect the mains lead to an AC wall outlet after completing all of the previous connections.

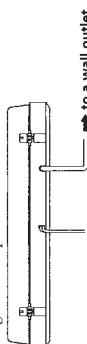

Playing a Record

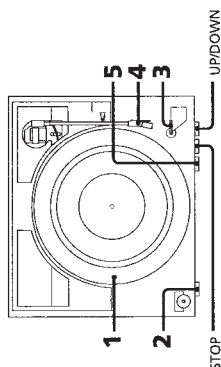

- 1 Place a record on the platter.

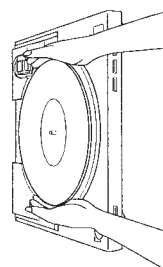

Note

Place only one record on the platter at a time. If two or more records are stacked on the platter, the stylus will not make proper contact with the grooves and the quality of reproduction will be impaired.

- 2 Press the Speed select button to select the speed.
- 3 Set the SIZE SELECTOR to 17 or 30.
- 4 Remove the protective cover from the cartridge, and close the dust cover.
- 5 Press START.
The platter starts rotating.
- 6 Adjust the volume on your amplifier.

To stop playing
Press STOP.

To pause playback

Press the UP/DOWN button to raise the stylus off the record.

To listen to a different part of the record

- 1 Press UP/DOWN button.
- 2 Move the tone arm to the position you desire.
- 3 Press UP/DOWN button.
The tone arm descends to the record.

To play a 17-cm record

Place the supplied 45 r/min adaptor on the spindle. When you have finished using the adaptor, put it back in the adaptor tray.

5GB

SAFETY-RELATED COMPONENT WARNING !!

COMPONENTS IDENTIFIED BY MARK OR DOTTED LINE WITH MARK ON THE SCHEMATIC DIAGRAMS AND IN THE PARTS LIST ARE CRITICAL TO SAFE OPERATION. REPLACE THESE COMPONENTS WITH SONY PARTS WHOSE PART NUMBERS APPEAR AS SHOWN IN THIS MANUAL OR IN SUPPLEMENTS PUBLISHED BY SONY.

SECTION 2 EXPLODED VIEWS

NOTE:

- Items marked “*” are not stocked since they are seldom required for routine service. Some delay should be anticipated when ordering these items.
- The mechanical parts with no reference number in the exploded views are not supplied.

- Hardware (# mark) list and accessories and packing materials are given in the last of this parts list.
- Abbreviation
CND : Canadian

The components identified by mark \triangle or dotted line with mark \triangle are critical for safety. Replace only with part number specified.

2-1. STEREO TURNTABLE SYSTEM-1

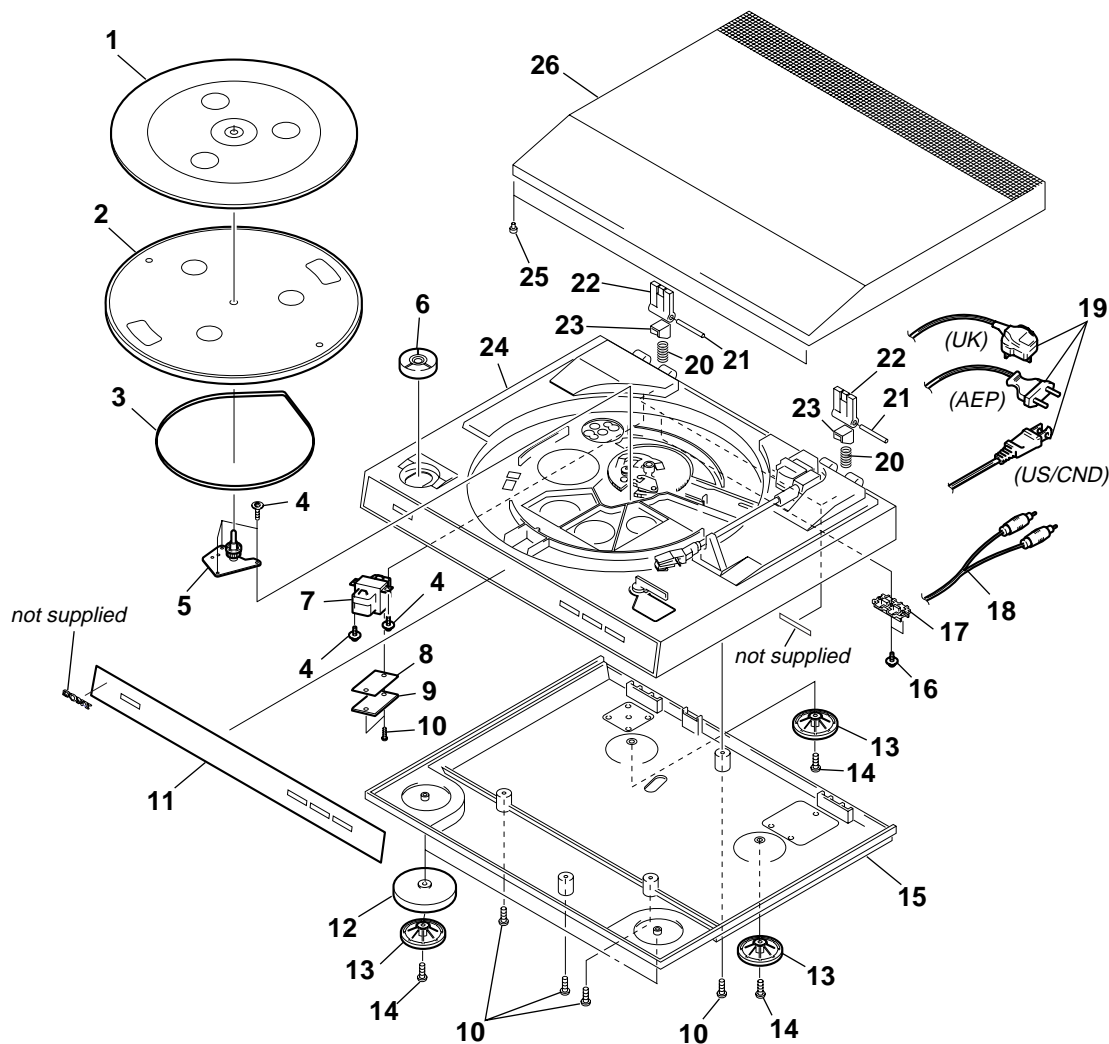

Ref. No.	Part No.	Description	Remark	Ref. No.	Part No.	Description	Remark
1	4-215-488-01	PLATTER MAT		15	4-215-519-01	BOTTOM PLATE	
2	4-215-491-01	PLATTER		16	4-215-533-01	SCREW	
3	4-215-492-01	BELT		17	4-215-508-01	PRESS SET	
4	4-215-531-01	SCREW		18	1-790-382-11	CORD, CONNECTION	
5	4-215-494-01	PLATTER SHAFT SET ASSY		\triangle 19	1-575-975-11	CORD, POWER (CND)	
6	4-215-489-01	45 PRM ADAPTAR		\triangle 19	1-783-531-51	CORD, POWER (US)	
\triangle 7	1-433-956-11	TRANSFORMER, POWER (US/CND)		\triangle 19	1-575-651-61	CORD, POWER (AEP)	
\triangle 7	1-433-957-11	TRANSFORMER, POWER (AEP/UK)		\triangle 19	1-696-572-21	CORD, POWER (UK)	
8	4-215-551-01	INSULATOR		20	4-215-574-01	SPRING	
* 9	A-4405-712-A	POWER BOARD, COMPLETE		21	4-215-573-01	PIN	
10	4-215-534-01	SCREW		22	4-215-571-01	HINGE	
11	4-220-775-01	PLATE, ORNAMENTAL		23	4-215-572-01	INSER SLIDER	
12	4-215-552-01	FOOT RING		24	4-215-518-01	PANEL	
13	4-215-560-01	RUBBER FOOT		25	4-215-559-01	RUBBER FOOT FOR DUST COVER	
14	4-215-536-01	SCREW		26	4-215-517-01	DUST COVER	

2-2. STEREO TURNTABLE SYSTEM-2

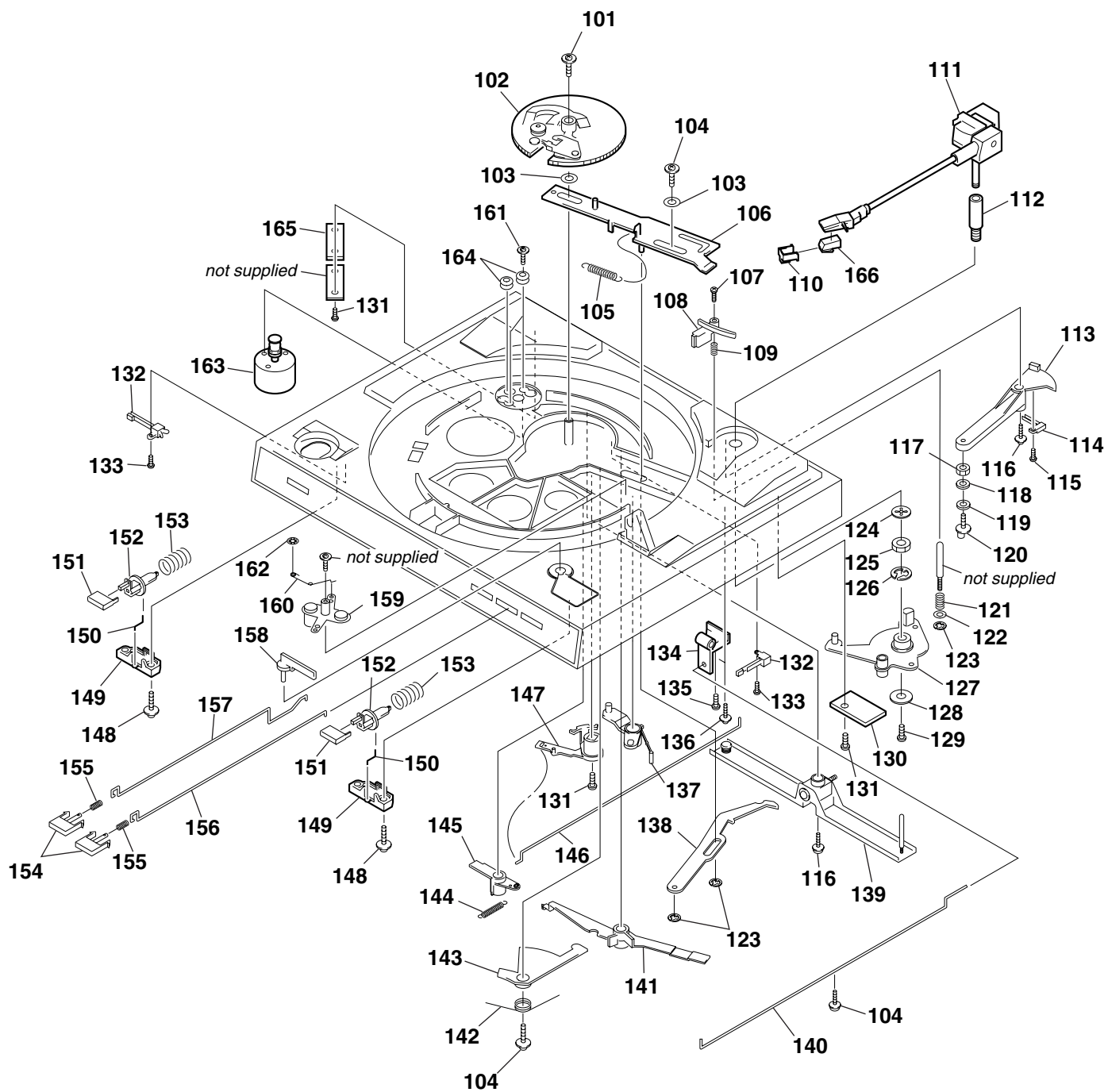

Ref. No.	Part No.	Description	Remark
101	4-215-539-01	SCREW	
102	4-215-493-01	CAM GEAR ASSY	
103	4-215-523-01	COPPER WASHER	
104	4-215-540-01	SCREW	
105	4-215-545-01	SPRING	
106	4-215-577-01	RETURN LINK ASSY	
107	4-215-535-01	SCREW	
108	4-215-507-01	LIFTER	
109	4-215-543-01	SPRING	
110	4-215-490-01	STYLUS (ATN 3600 LX)	
111	4-215-497-01	TONEARM ASSY	
112	4-215-583-01	TONEARM SHAFT SET	
113	4-215-584-01	FIXING SWITCH SET	
114	1-771-597-11	LEAF SWITCH	
115	4-215-587-01	SCREW	
116	4-215-537-01	SCREW	
117	4-215-586-01	BOLT	
118	4-215-588-01	SPRING WASHER	
119	4-215-589-01	WASHER	
120	4-215-585-01	SHAFT	
121	4-215-558-01	SPRING	
122	4-215-582-01	WASHER	
123	4-215-563-01	E-RING WASHER 3	
124	4-215-566-01	WASHER	
125	4-215-530-01	BOLT	
126	4-215-564-01	E-RING WASHER 5	
127	4-215-510-01	STARTING LEVER	
128	4-215-562-01	WASHER	
129	4-215-538-01	SCREW	
* 130	1-672-576-11	REF BOARD, COMPLETE	
131	4-215-532-01	SCREW	
132	1-771-596-11	LEAF SWITCH	
133	4-215-542-01	SCREW	
134	4-215-513-01	OIL SHAFT SET	
135	4-215-520-01	SCREW	
136	4-215-576-01	SCREW	
137	4-215-504-01	PENDULUM (M)	

Ref. No.	Part No.	Description	Remark
138	4-215-524-01	CONTROL PLATE	
139	4-215-495-01	CUEING LEVER ASSY	
140	4-215-570-01	SPRING FOR CUEING	
141	4-215-511-01	STARTING SUPPORT	
142	4-215-546-01	SPRING	
143	4-215-503-01	PENDULUM (L)	
144	4-215-544-01	SPRING	
145	4-215-509-01	PENDULUM (S)	
146	4-215-550-01	CUEING	
147	4-215-512-01	SELECTOR	
148	4-215-533-01	SCREW	
149	4-215-506-01	KNOB SET	
150	4-215-525-01	STEEL CRAMPER	
151	4-215-502-01	SPEED CUEING KNOB	
152	4-215-575-01	KNOB SHAT	
153	4-215-526-01	SPRING	
154	4-215-501-01	PLAY STOP KNOB	
155	4-215-557-01	SPRING	
156	4-215-569-01	SPRING (STOP)	
157	4-215-556-01	SPRING (PLAY)	
158	4-215-505-01	SELECT RECORD KNOB	
159	4-215-514-01	SELECT PLATE	
160	4-215-547-01	SPRING	
161	4-215-541-01	SCREW	
162	4-215-565-01	CS WASHER 3	
163	1-763-247-11	MOTOR ASSY (INCLUDING PULLEY)	
164	4-215-561-01	RUBBER FOOT FOR MOTOR	
165	A-4424-115-A	EQ BOARD, COMPLETE	
166	4-225-230-01	CARTRIDGE	

ACCESSORIES & PACKING MATERIALS			

		3-866-873-11	MANUAL, INSTRUCTION (ENGLISH, FRENCH)
		3-866-873-21	MANUAL, INSTRUCTION (GERMAN, SPANISH, DUTCH, SWEDISH, ITALIAN, RORTUGUESE) (AEP)
		4-215-488-01	PLATTER MAT
		4-215-489-01	45 PRM ADAPTAR
		4-215-491-01	PLATTER
		4-215-492-01	BELT

REVISION HISTORY

Clicking the version allows you to jump to the revised page.

Also, clicking the version at the upper right on the revised page allows you to jump to the next revised page.

[illegible]